

FABRIC SAMPLE	SKU	YD	CUT
	A Morning Glories 3012-72 Ivory Peach	2/3 YD	(4) 6 1/2" x 12 1/2" strips (6) 6 1/2" squares <i>watch direction of fabric when cutting rectangles</i>
	B Freesia 3015-26 Rose	2/3 YD	(4) 6 1/2" x 12 1/2" strips (6) 6 1/2" squares <i>watch direction of fabric when cutting rectangles</i>
	C Plumes 3022-72 Ivory Peach	1/2 YD	(8) 6 1/2" squares
	D Garden Damask 3021-77 Ivory	1/3 YD	(4) 1 1/2" x WOF* strips. Trim to fit. (4) 5 1/2" squares for corner stones
	E Key Stripe 3020-42 Olive Aubergine	1/2 YD	(2) 2" x 18 1/2" strips (5) 2" x WOF strips. Trim to fit.
	F Swirling Vine 3023-26 Pink Blush	1/2 YD	(4) 4" x WOF* strips. Trim to fit.

*WOF = width of fabric

A) BLOCK ASSEMBLY

This quilt consists of 2 of each of the blocks below.

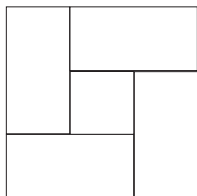

DIAGRAM FOR BLOCKS 1 AND 4

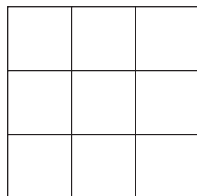
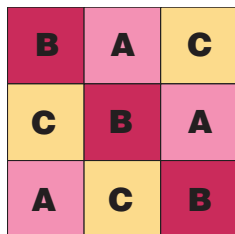
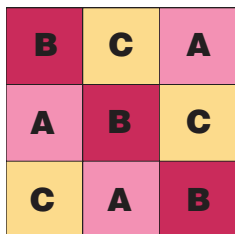

DIAGRAM FOR BLOCKS 2 AND 3

MAKING BLOCKS 2 and 3 make a ninepatch using 6 1/2" squares; and follow photo. *Note: Blocks 2 and 3 are the same, but fabrics are positioned differently.*



MAKING BLOCKS 1 and 4

Follow quilt photo and directions below for making partial seams.

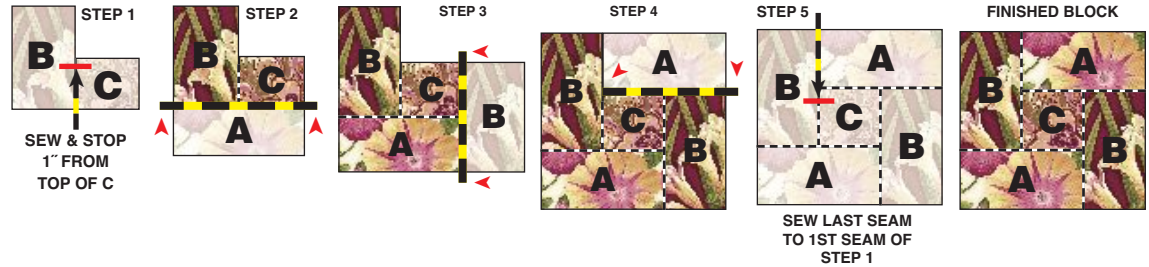

B) QUILT ASSEMBLY

- 1) Add one 2" x 18 1/2" strip of **Key Stripe E** to the bottom of **Blocks 1 and 2**.
- 2) Sew **Block 1** to **Block 3**. Press. Then sew **Block 2** to **Block 4**. Press.
- 3) Add a 2" x WOF strip **E** to right side of **Block 1-3** unit. Attach **Block 2-4** and **Block 1-3** units.
- 4) Sew one 1 1/2" x WOF strip of **Garden Damask D** to the top and bottom of quilt center. Trim to fit. Repeat for sides of quilt.

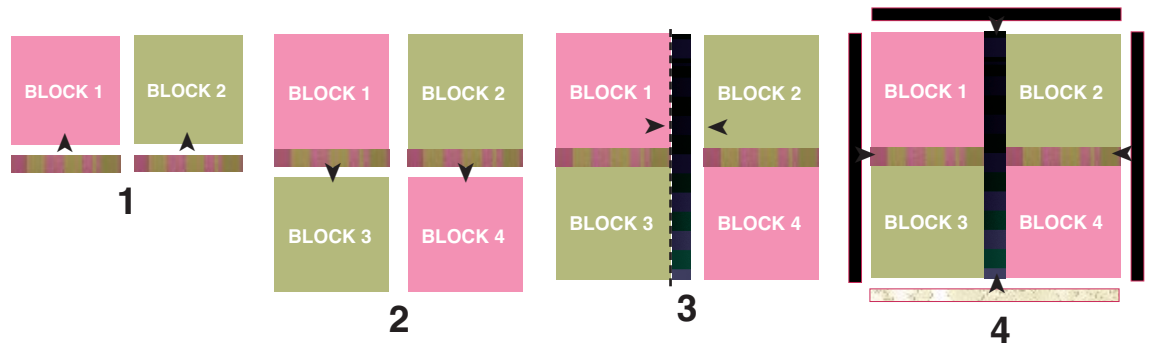

- 5) Sew one 2" x WOF strip of **Key Stripe E** to one 4" strip of **Swirling Vine F**, as shown on left. Make 4. Sew 2 strips to left and right of quilt.

- 6) To the remaining **E-F** strips add corner squares of **Garden Damask D** as shown below. Attach new units **E-F-D** to top and bottom of quilt center.



- 7) **FINISHING.** Cut batting and backing 3" larger than top top on all sides. Assemble the quilt sandwich by placing the backing, batting and top together in layers and baste or pin with safety pins. Machine quilt as desired. When quilting is completed, trim excess batting and backing. Bind in the usual manner.

